

**COMMERCIAL**

# HOMEKORE

**RESIDENTIAL**

MANUFACTURING COMPANY OF MA, INC.

*Manufacturers of Panelized Wood Structures Since 1978*

GARAGES ★ ADDITIONS ★ STORAGE BUILDINGS ★ HOMES ★ CUSTOM DESIGNS

117 Eastman St. Route 106 Easton, MA 02356

800-696-0027 (MA only)

## MODULAR GARAGES

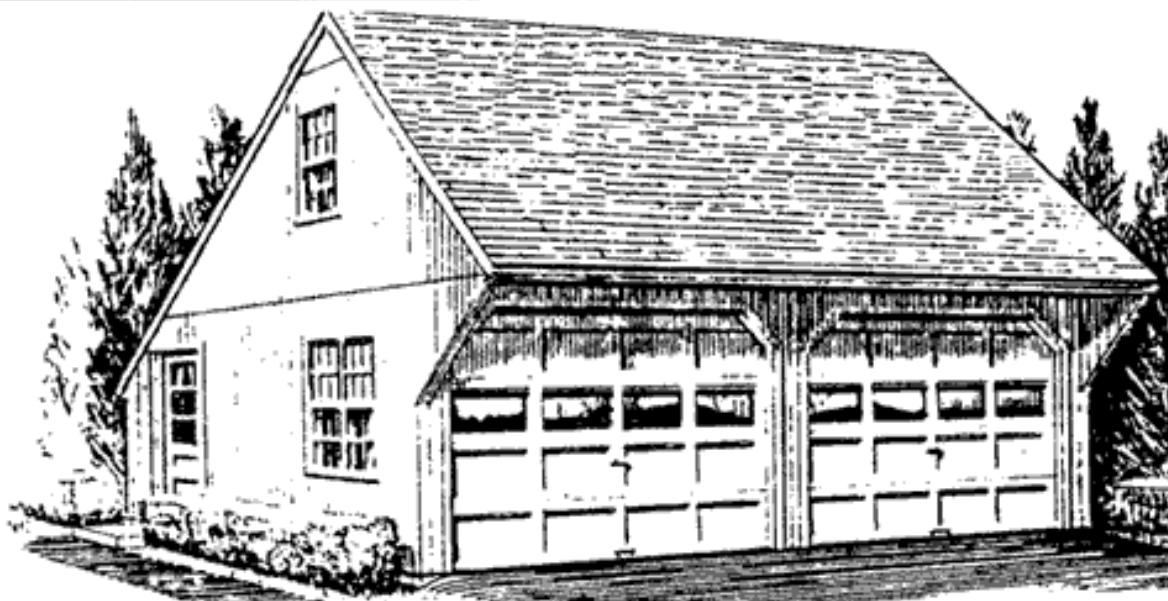

### WHAT DOES PANELIZATION MEAN TO YOU?

#### *Factory Quality:*

The exterior walls of your garage are assembled into conveniently sized panels. The latest in CAD technology is used to determine panel break points that ensure the necessary stability and precision of your walls.

#### *Easy to Build:*

You will find that with **HOMEKORE** panelized garages the layout, nailing and corner bracing of the panels have all been completed by framers in our factory. Our job is to align and erect the panels according to the layout.

#### *Time and Labor Savings:*

When your **HOMEKORE** garage is panelized, the windows and door openings are pre-assembled to rough size required for your garage. We begin by positioning the panels on the foundation. Within *days not weeks* your garage is ready to protect your investment.

**It is as  
simple  
as...**

**1.**

Install foundation then install tilt-up wall panels.

**2.**

Install roof and gable trusses.

**3.**

Nail on roof plywood and roof shingles, install doors, window and trim.

# OPTIONAL SIDINGS TO PICK FROM

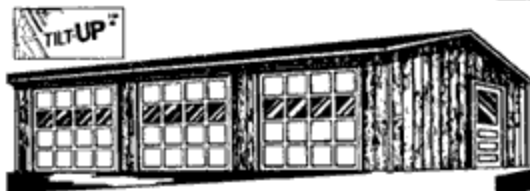

22' W x 32' L  
**'PAXTON' 3 CAR GARAGE**

All lumber is standard Grade and better. Includes all Hardware.



24' W x 24' L  
**2 CAR GARAGE** with Loft for Future Storage



16' W x 24' L  
**1 1/2 CAR GARAGE** with Storage



24' W x 24' L  
**2 CAR GARAGE** with a Service Door



12' W x 24' L  
**2 CAR GARAGE** without a Service Door



20' W x 32' L  
**'STRATFORD' 2 CAR GARAGE**  
Dad's Retreat, a 12' x 20' workshop with a 20' x 20' garage all in one.

## Options Available:

- ◆ **HOMEKORE** can retrofit your existing foundation with its panelization packages
- ◆ Removal of existing garages
- ◆ Garage can be customized to meet your specifications
- ◆ Just give **HOMEKORE** the information and we will panelize it and within days you can be protecting your investment
- ◆ **HOMEKORE** offers many different size garages

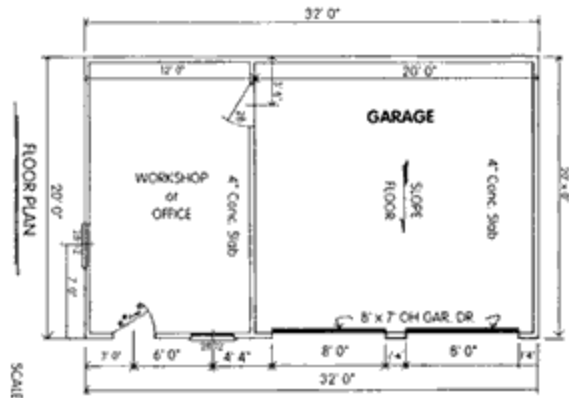

# Will Complement Your Yard & Home



24' W x 24' L  
**'DANBURY' 2 CAR  
SIDE GABLE GARAGE**  
8' W x 7' L overhead sectional garage doors.



20' W x 22' L  
**'HARTFORD' 2 CAR  
GAMBREL GARAGE**  
Includes upstairs floor for storage. Solid construction guaranteed.



16' W x 20' L  
**'NEWARK' 1 1/2 CAR  
SALT BOX GARAGE**  
Enough room for your car and extra shelving or a workbench so you can work indoors. Choose from a variety of optional sidings that will match your home.



12' W x 22' L  
**'MONROE' 1 CAR  
FRONT GABLE GARAGE**  
The Monroe package can be completed in a couple of weekends at guaranteed lowest prices.

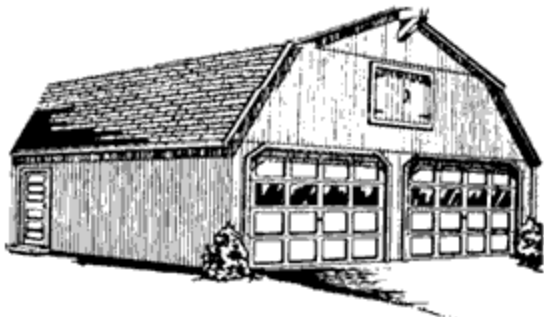

24' W x 24' L  
**'HALIFAX' GAMBREL 2 CAR GARAGE**  
Spacious two car garage. Includes second floor.



24' W x 24' L  
**'EASTON'  
2 CAR - 2 STORY GARAGE**  
Full 2nd story ready to use. 2-8x7 overhead sectional garage doors.

# Many Sizes And Styles Available With Several Siding Options!



20' W x 22' L  
**'GORHAM' 2 CAR CARRIAGE GARAGE**



24' W x 24' L  
**'ASBURY' 2 CAR FRONT GABLE GARAGE**



24' W x 22' L  
**'NANTUCKET' 2 CAR SALT BOX GARAGE**



20' W x 22' L  
**'DOVER' 2 CAR HIP ROOF GARAGE**



14' W x 22' L  
**'SALEM' 1 CAR SALT BOX GARAGE**



12' W x 22' L  
**'MONMOUTH' 1 CAR GABLE GARAGE**



24' W x 24' L  
**'DUXBURY' 2 CAR GARAGE**

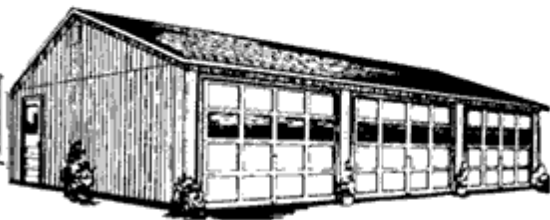

22' W x 32' L  
**'PLYMOUTH' 3 CAR GARAGE**

**Call: 1-800-696-0027 (MA only)**

**COMMERCIAL**

# HOMEKORE

**RESIDENTIAL**

MANUFACTURING COMPANY OF MA, INC.

*Manufacturers of Panelized Wood Structures Since 1978*

GARAGES ★ ADDITIONS ★ STORAGE BUILDINGS ★ HOMES ★ CUSTOM DESIGNS

117 Eastman St. Route 106 Easton, MA 02356

800-696-0027 (MA only)

## MODULAR GARAGES

*If it Can be Stick Framed it Can be Panelized  
Quicker with More Cost Control!*

### Specifications:

- ◆ All Kiln Dried Lumber # 2 and Better
- ◆ Pressure Treated 2" x 6" Sills
- ◆ Studding 2" x 4", 16" On Center
- ◆ 1/2" CDX Fir Sidewall Sheathing
- ◆ 2" x 4" Plates & Shoes
- ◆ Corner Post Triple 2" x 4" s
- ◆ Steel Overhead Garage Doors
- ◆ 2" x 10" or Engineered Door Headers
- ◆ Certified Engineered Roof Trusses 24" On Center
- ◆ 5/8" CDX Fir Roof Sheathing
- ◆ 15 Lb. Felt Paper
- ◆ 25 Year Self Sealing Roof Shingles
- ◆ Maintenance Free Vinyl Double - Hung Windows With Half Screens
- ◆ Pre-Primed #2 Wood Trim
- ◆ Steel Passage Entry Door With Hardware
- ◆ All Required Flashings
- ◆ Plans
- ◆ Excavation
- ◆ Foundation
- ◆ Permitting
- ◆ Concrete Slab
- ◆ Gutters and Downspouts

### Siding Options:

- ◆ Red Cedar Clapboard
- ◆ Primed Cedar Clapboard
- ◆ Vinyl and Aluminum Coverage
- ◆ Texture - 111
- ◆ Eastern White Cedar
- ◆ Optional Folding Stairway To The Attic for Easy Storage

16' W x 20' L  
**'HATFIELD' GAMBREL****1 1/2 CAR GARAGE**

A 1 1/2 car garage with enough room for hanging tools or shelving, and a second floor that lends itself perfectly as a loft for larger storage capacity.

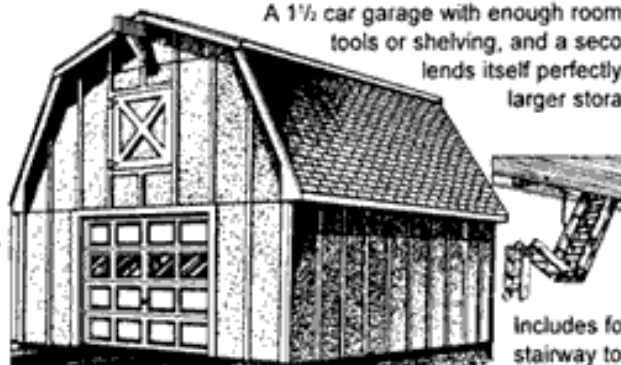

Includes folding attic stairway to make access to the loft storage easier.

24' W x 24' L  
**'ANDOVER' 2 CAR  
FRONT GABLE  
GARAGE**

Pre-engineered to eliminate the amount of waste in each project

20' W x 22' L  
**'MORGAN' 2 CAR  
FRONT GABLE GARAGE**

Many sidings available.

[www.homekore.com](http://www.homekore.com)

MA Builders Lic. # 031375

# ALSO AVAILABLE

## ROOM ADDITIONS & STORAGE SHEDS

with the  
*Same Quality and Craftmanship as HOMEKORE's Garages*  
**Room Additions FOR ADDED LIVING SPACE**

Add Equity and Space With Your **HOMEKORE** Room Addition Program Now

We offer Standard Room Additions where you can start out with your basic addition and continue to the exact final floor plan that fits your budget. We offer Design services, Top Quality Products and Materials to complement your home Call 1-800-696-0027.

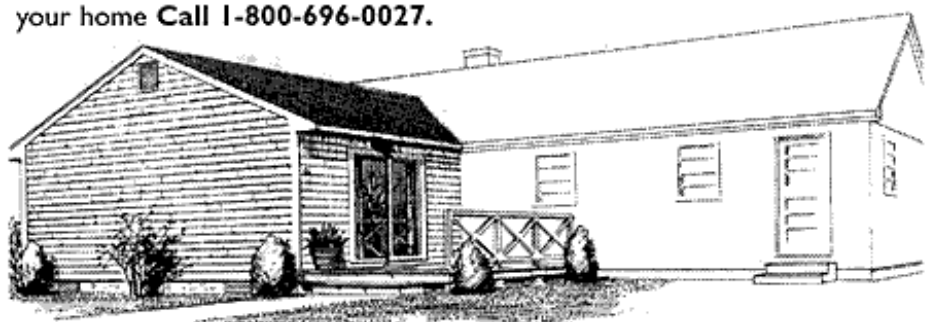

**14' x 18' Room Addition**

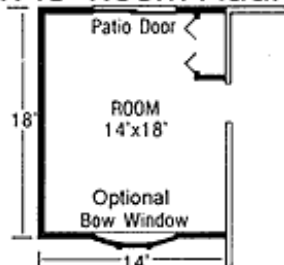

**20' x 22 Room Addition**

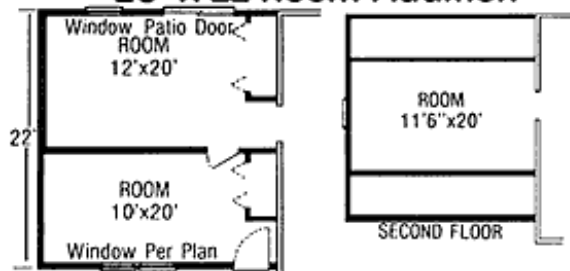

## Sheds FOR ALL SEASONS

**HOMEKORE** offers Superior Quality, Craftmanship & Design in its Storage Shed Construction.

- Siding Options: Cedar, Pine, Vinyl & TX-111 • 7 foot high walls allows for more storage space • 42 different Designs to chose from
- Customize your door & window placements • Free delivery to more areas • All Sheds are Installed by our carpenters
- Senior Discounts • Call 1-800-696-0027 for your brochure now.

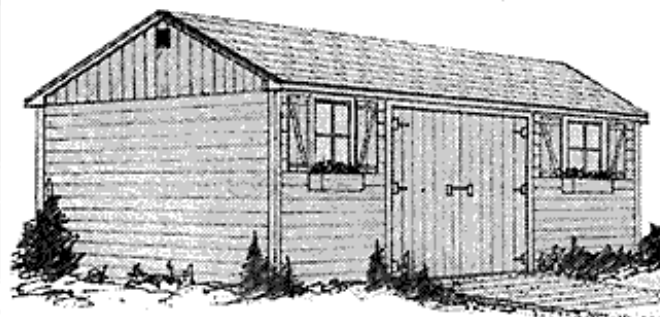

8' x 12', 10' x 12' & 12' x 12'  
**'LEXINGTON'**

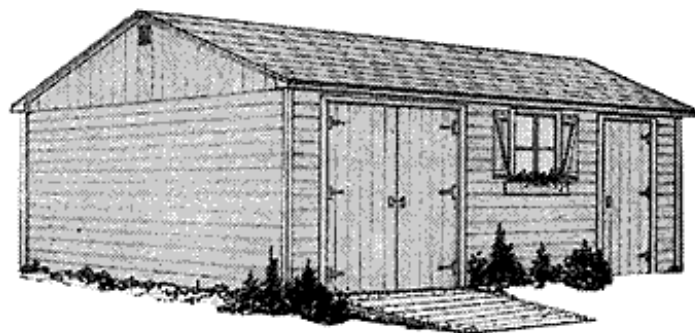

10' x 20', 12' x 20', 8' x 16', 10' x 16' & 12' x 16'  
**'NEW ENGLANDER'**